

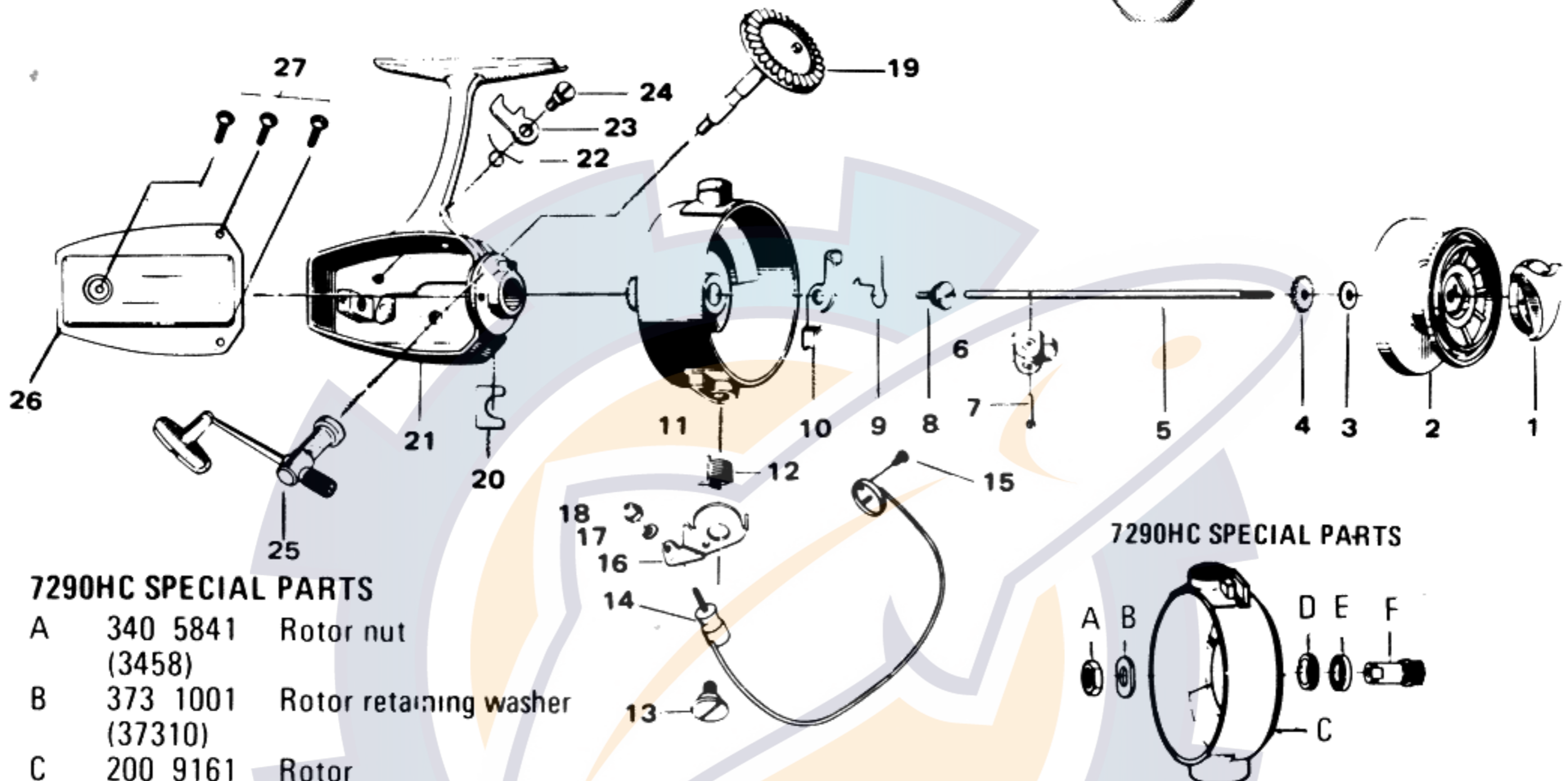

SPINNING REEL 7290C 7290HC



7290HC SPECIAL PARTS

- A 340 5841 Rotor nut (3458)
- B 373 1001 Rotor retaining washer (37310)
- C 200 9161 Rotor (2091)
- D 340 7721 Ball bearing ret' nut (3477)
- E 631 6901 Ball bearing (63169)
- F 401 2501 Pinion (40125)

7290HC SPECIAL PARTS

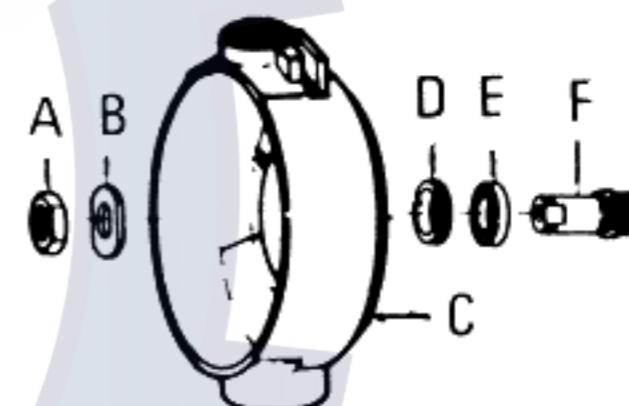

LINE CAPACITY: 250 YDS., 8 LB. TEST

Key No	Parts No.	Parts Name	Key No	Parts No.	Parts Name	Key No.	Parts No.	Parts Name
1	440 9521 (4495)	Drag knob	13	361 3931 (36139)	Arm lever screw	24	351 7201 (35172)	Anti-reverse screw
2	008 3821 (A00527)	Spool assembly	14	005 0021 (A00500)	Bail	25	007 9211 (A00502)	Handle
3	371 6901 (37169)	Spool washer	15	351 7501 (35175)	Bail holder screw	26	007 9501 (06163)	Body cover
4	270 2801 (2728)	Click	16	230 7011 (2370)	Arm lever	27	352 0401 (35204)	Body cover screw
5	391 6301 (39163)	Main shaft	17	160 0121 (1601b)	Bail washer	(11 & 21 7290C only)		
6	480 2011 (4820a)	Oscillating slider	18	340 2011 (3420a)	Bail nut	For 7290HC only		
7	490 4301 (4943)	Oscillating slider pin	19	411 8301 (41183)	Drive gear	14	005 2431 (A00524)	Bail
8	361 1512 (36115a-2)	Bail kick lever screw	20	372 5801 (37258)	Pinion retaining washer	15	351 6402 (35164)	Bail holder screw
9	140 6231 (1462b)	Bail kick lever spring	21	004 9821 (A00498)	Body	19	411 8211 (41182)	Drive gear
10	570 5531 (5755a)	Bail kick lever	22	141 1571 (14115a)	Anti-reverse claw spring	21	004 9921 (A00499)	Body
11	004 9711 (A00497)	Rotor	23	110 6701 (1167)	Anti-reverse claw	25	005 2511 (A00525)	Handle
12	140 9221 (1492a)	Bail spring				26	008 3901 (A00839)	Body cover